

# 8000 SERIES 5.1 MULTIMEDIA SPEAKER SYSTEM USER MANUAL

MODEL 160872



 **MANHATTAN™**

BRINGING COMPUTERS TO LIFE

MAN-160872-UM-1107-01



## INTRODUCTION

Thank you for purchasing the MANHATTAN® 8000 Series 5.1 Multimedia Speaker System, Model 160872.

These speakers feature internally powered amplifiers, making them compatible with computers and CD and DVD players, including portable versions of such devices. They are also completely shielded in terms of magnetization, and so will not interfere with the performance or operation of your computer or TV monitor. Follow the simple setup steps, and you'll soon be able to enjoy these great features:

- 2-way speakers offer vivid sound reproduction — ideal for games, movies and music
- Side-firing subwoofer radiates deep bass response
- Separate volume, bass and mute controls
- Distinctive styling complements flat-panel monitors and decor
- Full-function remote control adjusts settings from anywhere in the room
- Shielded to prevent distortion and maintain clear, crisp sound
- RMS power 70 W + 20 W x 5
- Front-mounted volume, bass and mute controls with indicator LEDs and remote control
- Black cloth speaker grilles
- Lifetime Warranty

## SAFETY PRECAUTIONS

Prior to the installation of your speakers, read the following safety guidelines to help prevent damage to any electrical components or harm to users.

- Do not place this product or any of its parts near heat or potential heat sources, nor in any moist or damp environment.
- Do not hit, drop or mishandle electrical components in such a way as to loosen, break or otherwise render inoperative any interior or exterior parts.
- Do not remove the back panel except as directed by a qualified technician in order to minimize the possibility of electrical shock. If in need of repair or inspection, bring the speaker(s) to a professional repair person.
- Should liquids or other materials (including fragments of broken parts) get inside the speaker cabinet, immediately shut power off to the speaker and have it professionally inspected and/or repaired before further operation. **NOTE:** Avoid using liquid cleaners/detergents on the cabinet surfaces, as this can damage the finish. A soft and clean damp cloth will suffice for cleaning the system exteriors.
- Turn off the power and unplug from the power source when the system is not in use.

## SETUP

1. Carefully unpack the speakers and accessories. Do not lift or remove the speakers from the box by the function knobs or other attachments as this may damage the speaker unit.
2. Place the satellite speakers and subwoofer in the desired listening location. (See the configuration example in Suggestions for Setup & Operation.)
3. Connect the input terminals of each satellite speaker to the corresponding output terminal on the rear panel of the subwoofer: FR for front-right; FL for front-left; RR for rear-right; RL for rear-left; C for center. **NOTE:** Match the polarity at the ends of each cable/connector: black/silver (negative polarity) to black/silver; red/gold (positive polarity) to red/gold.
4. Using the included RCA cable, connect the input jacks (stereo and 5.1) on the rear panel of the subwoofer unit to the corresponding line out or audio output jack(s) of the audio source (stereo tuner, computer, game system or whatever). **NOTE:** Connect to the headphone jack of the source if it's the only output available.

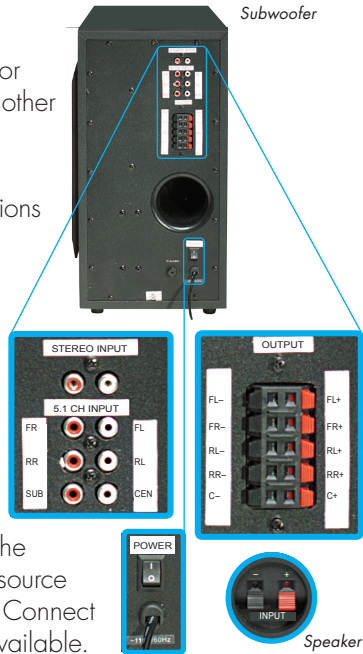

5. Plug the AC power cord (attached to the rear of the subwoofer unit) into an electrical outlet and set the main power button (also on the rear panel of the subwoofer) to the on position. This allows you to then use the more convenient controller on the front of the subwoofer and the button on the remote control to bring the speaker system out of the standby mode.
6. With the audio source turned on and generating an audio signal, adjust the volume and bass level of the speaker system to desired levels (adjusting the volume/audio output level on the audio source as necessary). **NOTE:** If connecting to a computer, you may want to conduct a sound card test. With the speakers properly connected and turned on, find the computer's sound card in the device manager and begin the test. Each channel should be able to be tested for sound and link. With the "test" window still open, turn up the volume on each channel (speaker). Test sound should be audible: If not, check and deactivate the mute feature (press mute button once) and do the test again.

## OPERATION

The one-key controller and LED indicators are located on the front panel of the subwoofer, with buttons that perform similar functions on the remote control (see Remote Control below).

### Power

When the main power button (on the rear panel of the subwoofer; see Setup Step 5) is in the on position, the ST\_BY LED lights red, indicating that the front-panel and remote controls are

ready for use. Rotate the one-key controller on the front panel clockwise and the ST\_BY LED lights blue or green, indicating that the speaker system has been activated.

### Mode (Stereo vs. 5.1 Ch)

To match the speaker output to the system's audio input, select between STEREO (CD mode) and 5.1 CH (DVD mode) by pressing the one-key controller for two seconds. The setting will switch from one to the other, with the corresponding LED indicating the active mode. The default mode is 5.1 CH.

### Volume

To adjust the volume of all the system speakers, simply rotate the one-key controller clockwise toward MAX to increase the volume, or counterclockwise toward MIN to decrease the volume. The ST\_BY LED flashes during volume adjustments.

To adjust the volume of individual or pairs of speakers: Press the one-key controller for one full second to select the front speakers (indicated by the FRONT LED lighting); press the controller twice to select the rear speakers (REAR); press the controller three times for the center speaker (CEN); press the controller four times to select the subwoofer (SUB). Rotate the controller to the desired position with each selection as explained above.

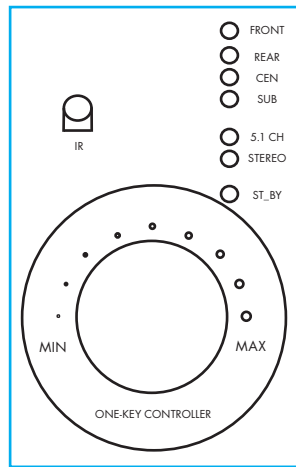

## IR

The infrared receiver (IR) accepts the signal from the remote control. Make sure nothing is placed in front of the receiver (or between the receiver and the remote control) that could interfere with the signal.

## REMOTE CONTROL

The buttons on the remote control unit perform the same functions as the controls on the front panel of the subwoofer except that, instead of a controller that selects individual and pairs of speakers, the remote control has separate buttons for raising and lowering the volume levels; for example, FRONT + and FRONT –.

**NOTE:** Be sure that the remote control unit is pointed directly at the IR sensor/receiver on the subwoofer (see Operation) whenever it's used; otherwise, the signal may not produce the desired results. Also, as advised in Safety Precautions, avoid hitting, dropping or otherwise mishandling the remote control, and keep it away from sources of excessive heat or moisture.



## SUGGESTIONS FOR SETUP & OPERATION

- Though featuring a magnetically shielded design so the speaker system is free from interference when placed near a monitor or TV, the subwoofer can *cause* interference in other components. Position the subwoofer at least 30 cm (1 ft.) away from monitors and TVs.
- If only one speaker emits CD audio when the system is plugged into a headphone jack, it's because WAV files and games normally transmit only one track of audio.
- Check all appropriate connections and controls (including those on the audio source) should one or more of the speakers not be producing sound once power is on. **NOTE:** If adjusting the SUB (subwoofer) volume control doesn't affect the audio output, it could simply be that the signal source doesn't include frequencies below 300 Hz (the upper range of the subwoofer).
- Before using the remote control, verify that the two AAA batteries (included) are properly inserted in the unit.
- As the subwoofer (bass) is not directional, it can be placed on the floor. Also, placing the subwoofer in the corner of the room or close to a wall can increase the bass effect. A suggested speaker configuration/ placement is presented at right.

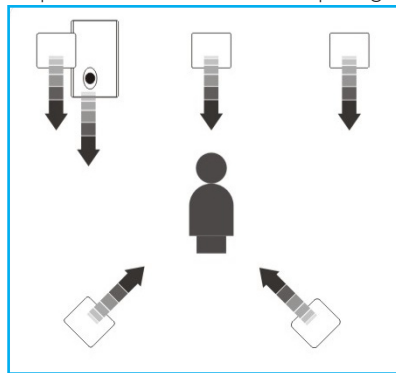

## SPECIFICATIONS

- RMS output power: 70 W + 20 W x 5
- Frequency response:
  - Satellites: 100 Hz – 20 kHz
  - Subwoofer: 20 Hz – 300 Hz
- Signal to noise ratio (S/N):  $\geq 70$  dB
- Total harmonic distortion (THD):  $\leq 0.3\%$
- Impedance:
  - Satellites (front, center, rear): 4 Ohms
  - Subwoofer: 8 Ohms
- Dimensions:
  - Satellites, front and rear: 9 x 12 x 100 cm (3.5 x 4.75 x 39.4 in.)
  - Satellites, center: 9 x 12 x 20 cm (3.5 x 4.75 x 7.9 in.)
  - Subwoofer: 21 x 41.5 x 36.5 cm (8.3 x 16.3 x 14.4 in.)
- Diameter, driver(s):
  - Satellites, front: 5.1 cm (2 in.); rear: 2.5 cm (1 in.); center: 7.6 cm (5.1 in.) and 2.5 cm (1 in.)
  - Subwoofer: 20.3 cm (8 in.)
- Power: internal power supply
- Connectors: RCA cables and adapters (included)





MANHATTAN® offers a complete line of PC Components, Peripherals, Cables and Accessories. Ask your local computer dealer for more information or visit us online at  
**[www.manhattan-products.com](http://www.manhattan-products.com)**

Copyright © MANHATTAN

All products mentioned are trademarks or registered trademarks of their respective owners.